

3000K

4000K

5000K

AFL50W3T  
Q5080350



Optional Accessory:  
PIR Sensor AFL50PIR / Q5080360  
Includes: Lux, Time & Sensitivity  
**Refer Page 4**



## SPECIFICATIONS & DIMENSIONS

Dimensions	H312 x W225 x D52mm
Cut Out	90mm
Colour Temp	Selectable 3000K 4000K 5000K
Lumens / Wattage	4200 Lumens, 30W 5600 Lumens, 40W 7000 Lumens, 50W
CRI	80 CRI
Lifespan	L70 60,000 hours
Beam Angle	120 degrees
Material	Aluminium + Glass + PC
IP Rating	IP66
IK Rating	IK08
Insulated	Double Insulated
Power Input	110-277V ~50/60Hz
Warranty	3 Years

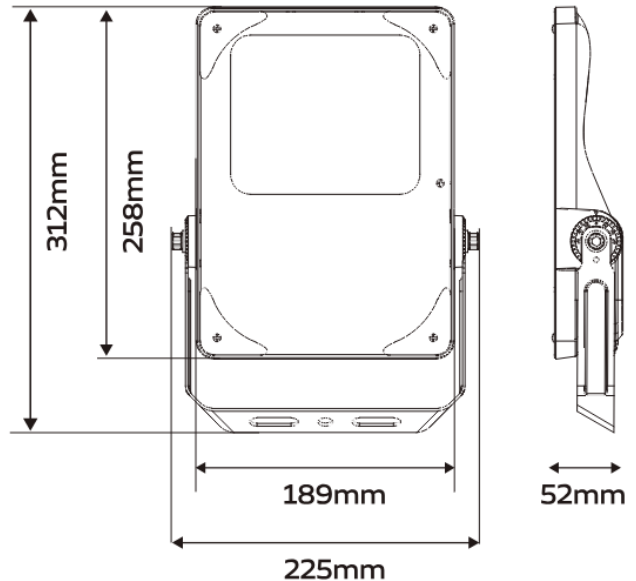

PLEASE READ AND UNDERSTAND ALL WARNINGS, CAUTIONS AND OPERATING INSTRUCTIONS IN THIS MANUAL BEFORE USING THIS EQUIPMENT. Failure to follow all instructions may result in electric shock, fire and/or serious personal injury.

## SAFETY WARNINGS

- Always read the instructions carefully before installation, failure to do this could result in damage to the product, property or harm to the installer.
- This product should be installed by a licensed electrician in accordance with the Australian / New Zealand Wiring Rules AS/NZS 3000.
- Do not immerse any part of the light fitting in water or any other liquids.
- Regularly inspect the light fitting to ensure that no damage has occurred, if damage is found cease use and replace.
- Do NOT attempt to modify this fitting in any way.
- The LED Driver and LED module is not replaceable.
- Do not stare directly into the lights. Prolonged exposure to bright lights could harm your eyes.
- This device should not be used by persons with reduced physical, sensory or mental capabilities or lack of experience and knowledge unless they have been given supervision or instruction concerning use of this appliance in a safe way and understand the hazards involved.
- Keep this product out of reach of children.
- This device is not intended for commercial, industrial or trade use.

## BEFORE YOU BEGIN

- Ensure power to the circuit is isolated for the duration of the installation.
- Ensure all packaging materials are fully removed prior to installation.
- When selecting a mounting location, choose an area where you can firmly attach to a solid support structure i.e. timber nogs, concrete wall. We do not recommend installing into areas without a solid structure.
- Check your mounting location carefully for concealed cables or pipes before beginning. You must be careful not to drill into or pierce a cable or pipe inside the wall structure.
- Always ensure the supporting surface will safely support the combined weight of the attached equipment and all attached hardware and components.
- Always double check your measurements and work before proceeding.
- Use a spirit level.
- Check you have the right tools and safety equipment to complete the installation.

## DISPOSAL

When this fixture is no longer used or required it should be disposed of with household waste. We recommend completing this in the most environmentally friendly way. Please recycle where facilities exist in your local area. Check with your council authority for recycling advice.

Recycling of packaging materials reduces the need for landfill. Please recycle packaging where possible. Check with your local council authority for recycling advice.

## INSTALLATION

**CAUTION: ISOLATE (TURN OFF) MAINS SUPPLY BEFORE CONNECTING.**

1. Select appropriate mounting position. **Fig 1.**
2. Using the bracket as a template, mark appropriate drilling position for mounting.
3. Fix mounting bracket using appropriate hardware.
4. Connect supply wiring to the terminal block. See **Fig 2.** Please ensure that any connection made complies with New Zealand Wiring Rules AS/NZS 3000.
5. Adjust the direction of the floodlight and tighten the head fixings.
6. Select desired **CCT**: 3000K (**Warm White**), 4000K (**Neutral White**), or 5000K (**Daylight White**). **Fig 3.**
7. Select required **power output (wattage)** via dip switch. **Fig 4.**
8. Energise the circuit at the mains, your light should now turn on.

**Fig.1**

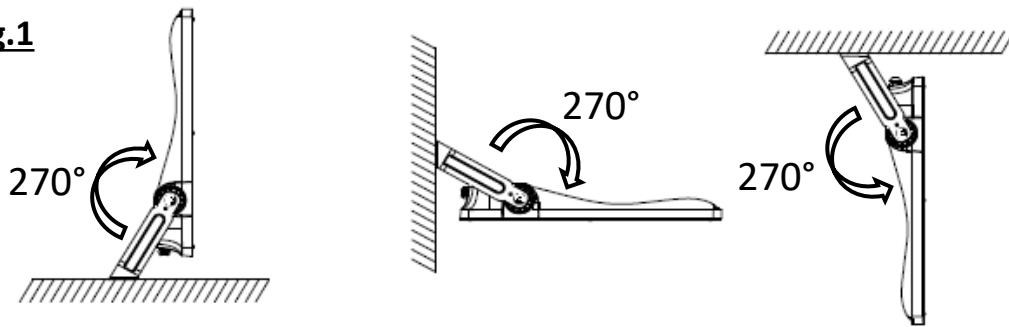

Horizontal Installation

Wall Mounting

Ceiling Installation

**Fig.2**

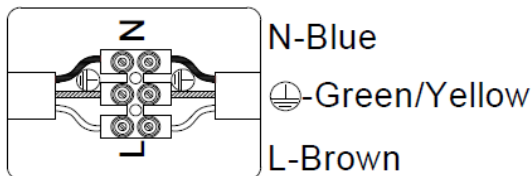

**Fig.3**

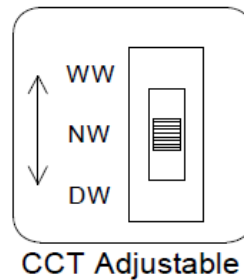

**Fig.4**

P	1	2
50%	-	ON
75%	ON	-
100%	-	-

Power Adjustable

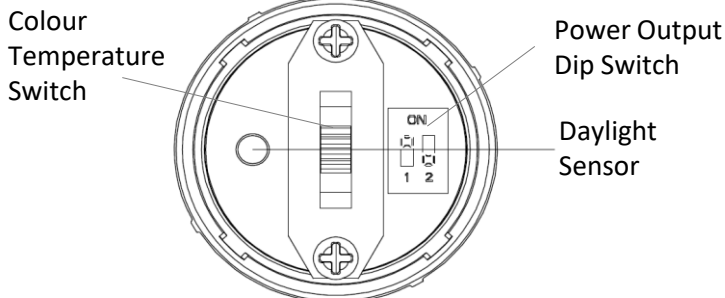

## WATER INGRESS

This product is rated IP66, and suitable for exterior installations. The product must not be exposed to conditions beyond IP66 protection, this includes during cleaning e.g. water blasting, chem wash etc.



### PRODUCT SPECIFICATION

Dimensions	H75 x W64 x D50mm
Rated Load	100W (LED Lamp)
Ambient Light	3-2000 Lux (Adjustable)
Time-Delay	Min: 10sec (+3sec) Max: 7min (+2min)
Detection Range	120 degrees
Working Temperature	-20~ + 40°C
Working Humidity	<93%RH
Installation Height	1.8m-2.5m
Detection Motion Speed	0.6-1.5m/s
Detection Distance	2-10m (<24C)
IP Rating	IP65
Material	PC
Power Input	220-240V ~50/60Hz
Warranty	3 Years

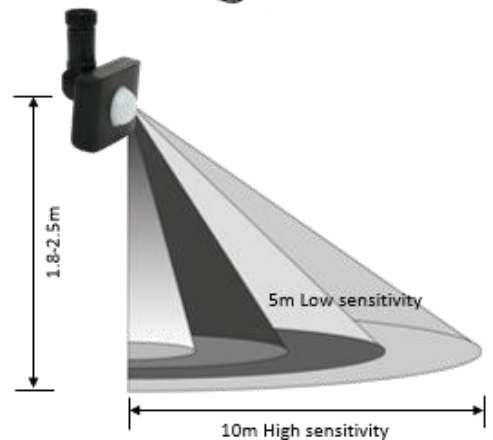
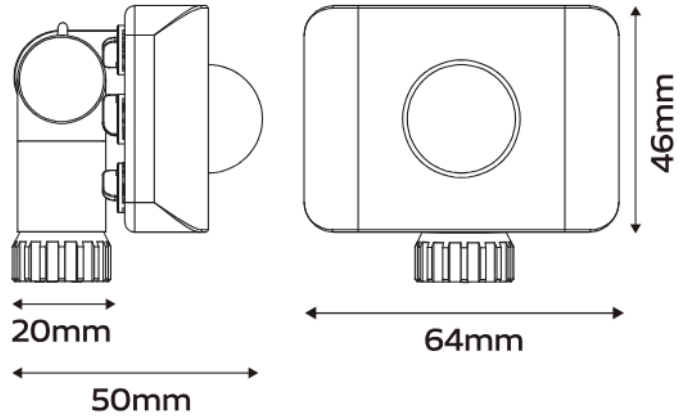

## OPTIONAL ACCESSORY - PIR SENSOR INSTALLATION

Ensure power is isolated from the Floodlight before installing the sensor.

1. Remove the cover from the Floodlight PIR mounting point.
2. Pull out the short circuit connection pin, ensure the rubber 'O' ring is still attached.
3. Plug in sensor ensuring the pins line up and tighten as shown.
4. Tune on the power and test function.

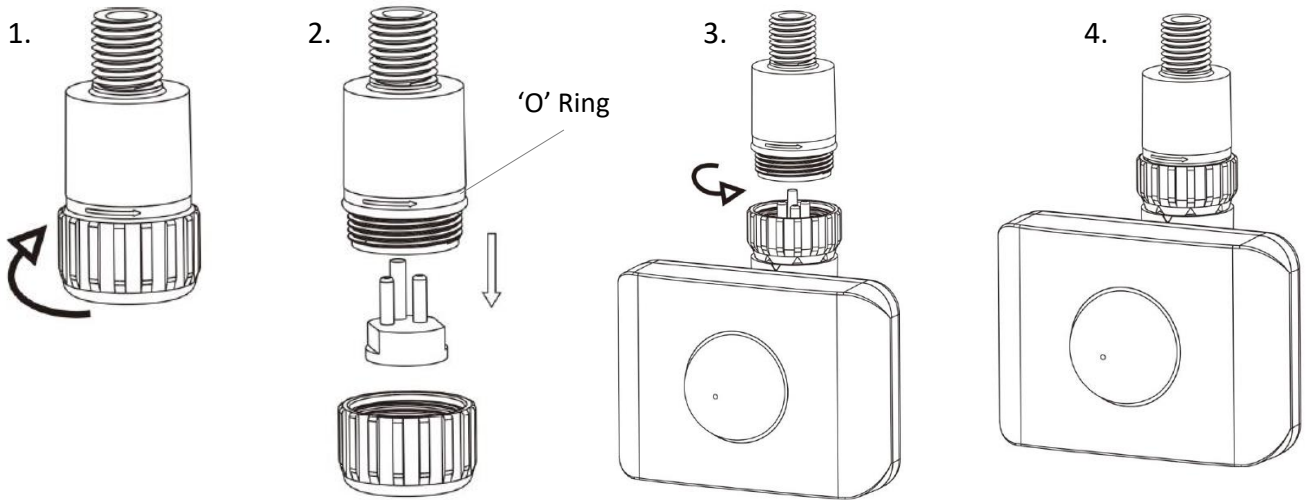

## SENSOR FUNCTION

1. The **TIME** the light remains on can be adjusted from approximately 10 seconds to approximately 12 minutes.
2. The **SENS** dial adjusts the detection distance. The lowest setting is 2m, which can be increased all the way up to 10m by turning the dial towards the "+" symbol.
3. When the **LUX** dial is turned to the sun symbol, the light will operate in any light. To have it operate only when it is dark (less than 10 LUX), turn the dial towards the moon symbol.
4. Any new movement re-sets the time and delays the moment the light goes off.



## WATER INGRESS

This product is rated IP65, and suitable for exterior installations. The product must not be exposed to conditions beyond IP65 protection, this includes during cleaning e.g. water blasting, chem wash etc.

## CARE AND CLEANING

To clean wipe exterior with a slightly damp cloth.  
Do not immerse in water.

## PROOF OF PURCHASE

Please retain your purchase receipt for all warranty claims

## WARRANTY

Your product is warranted against faults and manufacture defects when used as per instruction for a period of **three years**.

We undertake to replace this product at no charge if found to be defective due to a manufacturing fault during the warranty period. This warranty excludes damage caused by misuse, neglect, shipping accident, incorrect installation, or work carried out by anyone other than a qualified electrical service technician. It also excludes liability for discolouration of paint or plastic, or any user serviceable parts. It does not confer any rights other than those expressly set out above and does not cover any claims for consequential loss or damage.

If your product fails to operate satisfactorily, please return it to the retailer from whom it was purchased to obtain a repair or replacement product. You will need to produce satisfactory evidence of date of purchase. If the product is to be replaced (cannot be repaired) then that replacement will be of the same or similar product or accessory excluding packaging, instruction card etc.

In New Zealand product is covered by the Consumers Guarantee Act (1993). In accordance with the act consumers are advised that: The manufacturer does not undertake that repair facilities and parts are necessarily available for this product.

In Australia, our goods come with guarantees that cannot be excluded under the Australian Consumer Law. You are entitled to a replacement or refund for a major failure and compensation for any other reasonably foreseeable loss or damage. You are also entitled to have the goods repaired or replaced if the goods fail to be of acceptable quality and the failure does not amount to a major failure.

## KEEP IN A SAFE PLACE FOR FUTURE REFERENCE

**CDB  GROUP**

### **New Zealand**

PO Box 100-707

N.S.M.C

Auckland

Phone +64 (0)9 917 4000

Phone 0800 232 633

info@cdb.co.nz

### **Australia**

PO Box 574

South Morang

Victoria, 3752

Phone +61 (0)3 9336 4423

Phone 1300 465 324

info@cdbgoldair.com.au