

Installation & Owner Manual

LED Spot Light

AMBIUS

Product & Technical Information

Model: AT200
Supply: 220-240V ~ 50Hz 13W
Lamp: Integrated LED
Ingress Protection: IP55
Use: Indoor and Outdoor
Operating Position:
Rigid Vertical surface

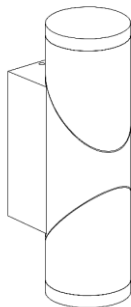

Safety Warnings

- Always read the instructions carefully before installation, failure to do this could result in damage to the product, property or harm to the installer.
- This product must be installed by a licensed electrician in accordance with the Australian / New Zealand Wiring Rules AS/NZS 3000.
- It is recommended that this product be used on a circuit board protected by an Earth Leakage Circuit Breaker or Safety Switch.
- Allow suitable ventilation around the light fitting and do not cover with any material.
- Do not immerse any part of the light fitting in water or any other liquids.
- Regularly inspect the light fitting to ensure that no damage has occurred, if damage is found cease use and replace.
- Do not attempt to modify this fitting in any way.

Installation Procedure

- Ensure all packaging materials are fully removed prior to installation.
1. Ensure power to the circuit is isolated for the duration of the installation. Remove the plastic fascia. (image 1)
 2. Remove the base by undoing 2 screws on each side of the fitting. (image 2)
 3. Select the appropriate mounting position. (image 3)
 4. Feed supply cable through base plate cable entry. (image 5)
 5. Route the supply cable so that the wiring is able to connect to the terminal block. (image 6)
 6. Connect the wiring to the terminal block:
 - a) Brown (Active) is connected to the contact marked 'A' or 'L'.
 - b) Blue (Neutral) is connected to the contact marked 'N'
 - c) If a Green/Yellow (Earth) wire is available it must be connected between the base plate and contact terminal marked with
 7. Once connection is made, place the fitting back onto the base and screw secure. (image 7)
 8. Do not swap the LED Driver for any other model, it is specific to this integrated LED fitting.
 9. Energise the circuit at the mains then turn the individual switch 'ON'.
 10. Your light should now operate.

Care and Cleaning

- The LED's inside this fitting are non-replaceable.
- To clean wipe exterior with a damp cloth.

Proof of Purchase

- Please retain your purchase receipt for all warranty claims

Warranty

Your product is warranted against faults and manufacture when used in normal domestic use for a period of one year.

We undertake to replace this product at no charge if found to be defective due to a manufacturing fault during the warranty period. This warranty excludes damage caused by misuse, neglect, shipping accident, incorrect installation, or work carried out by anyone other than a qualified electrical service technician.

If your product fails to operate satisfactorily, please return it to the retailer from whom it was purchased to obtain a repair or replacement product. You will need to produce satisfactory evidence of date of purchase. If the product is to be replaced (cannot be repaired) then that replacement will be of the same or similar product or accessory excluding packaging, instruction card etc.

In New Zealand product is covered by the Consumers Guarantee Act (1993). In accordance with the act consumers are advised that: The manufacturer does not undertake that repair facilities and parts are necessarily available for this product.

In Australia, our goods come with guarantees that cannot be excluded under the Australian Consumer Law. You are entitled to a replacement or refund for a major failure and compensation for any other reasonably foreseeable loss or damage. You are also entitled to have the goods repaired or replaced if the goods fail to be of acceptable quality and the failure does not amount to a major failure.

New Zealand
PO Box 100-707
N.S.M.C
Auckland

Phone +64 (0)9 917 4000
Phone 0800 232 633
info@cdb.co.nz

Australia
PO Box 574
South Morang
Victoria, 3752

Phone +61 (0)3 9336 4423
Phone 1300 465 324
info@cdbgoldair.com.au

